

Henry Musser  
Q 190

264-54

John Musser

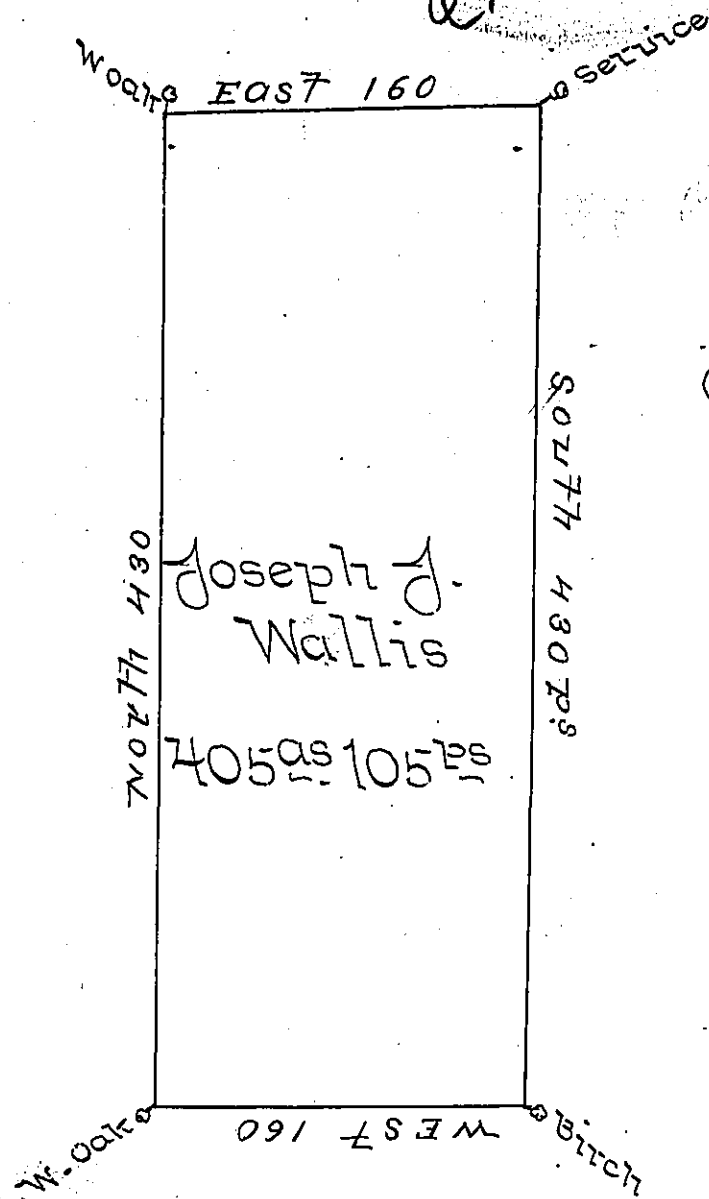

pg 29

Philip Bower

Situated on the Waters of Blacklick Creek in Wheatfield Township Westmoreland County Containing 405 acres & 105 perches & allowance for Roads &c surveyed for Joseph J. Wallis the 17<sup>th</sup> day of Novem<sup>r</sup> 1794 on Warrant dated the 3<sup>d</sup> day of May 1793

James Ross U.S.

Daniel Broadhead Esq.

IN TESTIMONY that the above is a copy of the original remaining on file in the Department of Internal Affairs of Pennsylvania, made conformably to an Act of Assembly approved the 16th day of February, 1833, I have hereunto set my Hand and caused the Seal of said Department to be affixed at Harrisburg, this sixth day of June 1899.

*James W. Patton*  
Secretary of Internal Affairs.